

Manual

W010 Remote control

1. Connect with the alarm by using the Smartphone app

Make sure that you have downloaded the latest version of the app. The alarm unit needs to be connected to a voltage source while pairing.

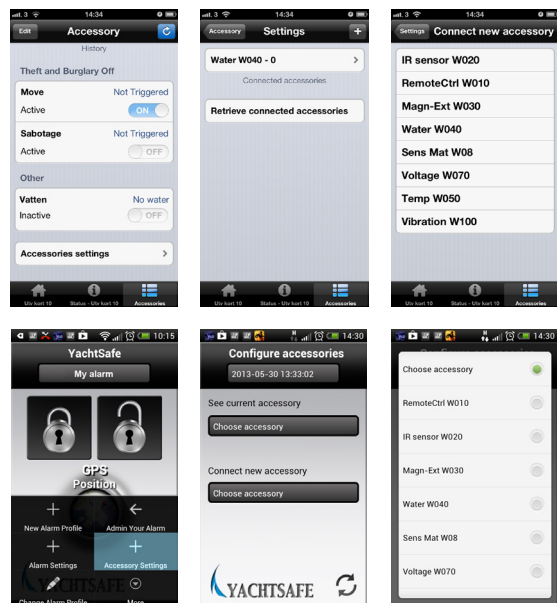

iPhone

1. Click on **Accessories** at the bottom right of the start page. Choose then **Accessories settings**.
2. Click on the plus button at the top right of the page.
3. Click on the accessory you want to connect. Later choose **Connect*** and follow the instructions.

Go to the status page for the accessories to activate the sensors of the accessories. The installation is now done.

*The little LED-light on the accessory starts flashing fast if the connection to the alarm is ok. If the attempt to connect fails the light is lighting up for 1-2 seconds. If you don't receive any feedback please try again.

Android

1. Click on the menu button at the bottom of the Android phone to see the box of alternatives. Choose later **Accessory Setting**.
2. Click on **Choose accessory** under **Connect new accessory**.
3. Click on the accessory you want to connect. Later choose **Connect*** and follow the instructions.

Go to the status page for the accessories to activate the sensors of the accessories. The installation is now done.

2. Mounting

The main function of the remote control is to turn on and off the GPS-alarm. There is also a SOS button that activates an alert message with position information which is sent to the predefined alarm numbers. It's also possible to put the alarm unit in a low power consumption mode or control power of an external device, e.g. a heater or fridge in a boat. The communication between the remote control and the alarm unit is bidirectional. When the remote is flashing, it means that the command is sent and the alarm unit has received the key press. One or several remote controls can be used for the same alarm unit.

- ❶ Activate the alarm for theft and burglary.
- ❷ Inactivate the alarm for theft and burglary.
- ❸ Send a text message with the position of the alarm unit by holding the button down for three seconds.
- ⊕ This button has two different functions.



- By pressing the button you can turn on or off the power of an external device, e.g. a heater or fridge if this is chosen.
- To switch to the low power consumption mode you hold down the button for about 10 seconds until the LED-light is flashing once. You also receive a text message with status information to your predefined alarm numbers. To switch back you just hold down the button again for about 10 seconds until the light is flashing.

Technical specification

Measurements:	58 x 30 x 11 mm
Battery lifetime:	up to 3 years
Type of battery:	CR1632
Battery capacity:	130 mAh
Distance range (free sight):	ca 100 m
Temperature range:	-30 to 70 °C
Sealing:	IP54

